

Chelston Approach, Ruislip, HA4

APPROX. GROSS INTERNAL FLOOR AREA 836 SQ FT 77.6 SQ METRES

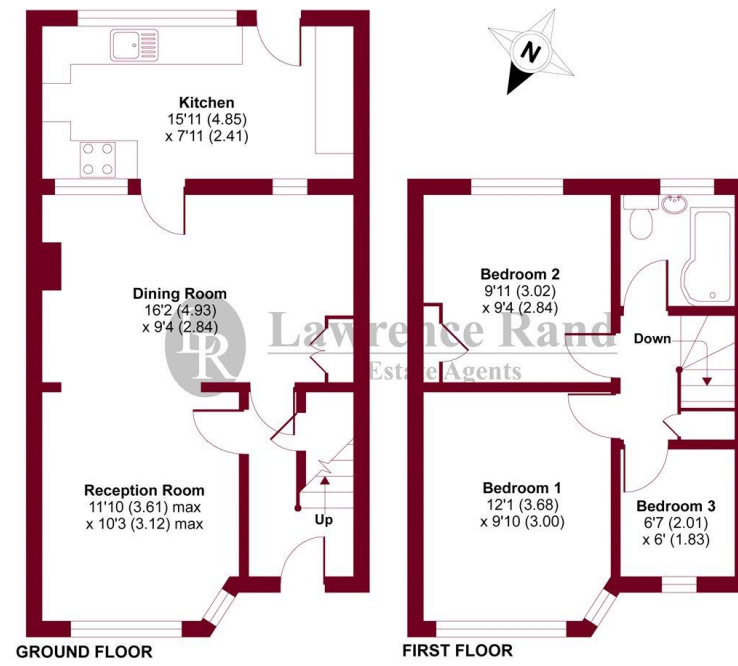

Whilst every attempt has been made to ensure the accuracy of the floor plan contained here, measurements of doors, windows and rooms are approximate and no responsibility is taken for any error, omission or misstatement. These plans are for representation purposes only as defined by RICS Code of Measuring Practice and should be used as such by any prospective purchaser. Specifically no guarantee is given on the total square footage of the property if quoted on this plan. Any figure given is for initial guidance only and should not be relied on as a basis of valuation.

Copyright nichecom.co.uk 2016 Produced for Lawrence Rand Estate Agents REF : 108657



Every care has been taken with the preparation of these Particulars but complete accuracy cannot be guaranteed. Always check the details before agreeing to purchase. This includes checking on the existence of relevant permissions. If there is any point, which is of particular importance to you, please obtain professional confirmation. Alternatively, we will be pleased to check the information for you. All measurements quoted are approximate. The Fixtures, Fittings & Appliances have not been tested and therefore no guarantee can be given that they are in working order. Photographs are reproduced for general information and it cannot be inferred that any item shown is included in the sale. Drawings/Sketches/Plans - This representation is provided for general guidance and is not to scale.

Chelston Approach Ruislip





**Chelston Approach
Ruislip
£1,650 per month**

Key features

- Mid terrace house
- Spacious through lounge
- Three bedrooms
- Garage
- Minutes' walk to local amenities

Property details

This very neatly presented three bedroom mid terrace B Type Manor family home is ideally located.

The accommodation briefly comprises of an entrance hallway with stairs to the first floor. Spacious light filled lounge leading through into the dining room area. Lovely modern fitted kitchen with a host of base and eye level units with contrasting work surfaces and flooring, single door provides access out to the rear garden.

To the first floor there are three inviting bedrooms, two doubles and a single all softly decorated. Fitted bathroom with wc, wash hand basin and a bath with overhead shower.

Attractive rear garden with garage accessed via rear service road. Neat front garden with lawned area, flower beds and pathway.

The property lies within easy walking distance to Ruislip Manor shopping and transport links and falls in the catchment area of many highly regarded schools.



We are local people who support our local community. We have unrivalled expertise and knowledge of the surrounding area

0208 866 2727
lawrence-rand.co.uk

