

Herlwyn Avenue  
Ruislip





Herlwyn Avenue  
Ruislip  
£340,000

Energy Efficiency Rating		Current	Potential
Easiest energy efficient - lower running costs			
(92-100)	A		
(81-91)	B		
(69-80)	C		
(55-68)	D		
(39-54)	E		
(21-38)	F		
(1-20)	G		
Not energy efficient - higher running costs			
England, Scotland & Wales		70	78
		EU Directive 2002/91/EC	

## Key features

- Two bedroom maisonette
- First floor
- Private entrance
- Modern fitted kitchen & bathroom
- Lounge
- Large private rear garden
- Just a short walk to shops & transport links



We are local people who support our local community. We have unrivalled expertise and knowledge of the surrounding area

## Property details

In an ultra-convenient location this well presented two double bedroom first floor maisonette has been tastefully decorated in soft warm tones. Benefitting from its own private entrance and a large private rear garden. This property would be an ideal starter home or investment opportunity.

The property is entered via its own private entrance with stairs leading to a small landing area and a large storage cupboard. The lounge has a front aspect window with plenty of natural light flooring the room. There is space for a sofa as well as a table and chairs. The neatly appointed modern fitted kitchen has a range of high gloss wall and base units, a good run of work surfaces and space for appliances. A double glazed door provides direct access to a balcony with steps leading down to the rear garden.

Both the Master bedroom and second bedroom are doubles. The Master bedroom benefits from a built in bespoke storage cupboard. To complete this lovely property is a fresh fully tiled bathroom comprising of a three piece suite.

Ruislip High Street is only moments away which boasts a vast array of coffee shops, restaurants, and local supermarkets. There are also outstanding transport links provided by Ruislip bus and train station servicing the Metropolitan and Piccadilly lines and a large number of bus routes. For the motorist the A40 is only a short drive away and provides access into Central London and the surrounding Home Counties.

 01895 632211  
 [lawrence-rand.co.uk](http://lawrence-rand.co.uk)



# Floorplan

## Herlwyn Avenue, Ruislip, HA4

APPROX. GROSS INTERNAL FLOOR AREA 582 SQ FT 54 SQ METRES

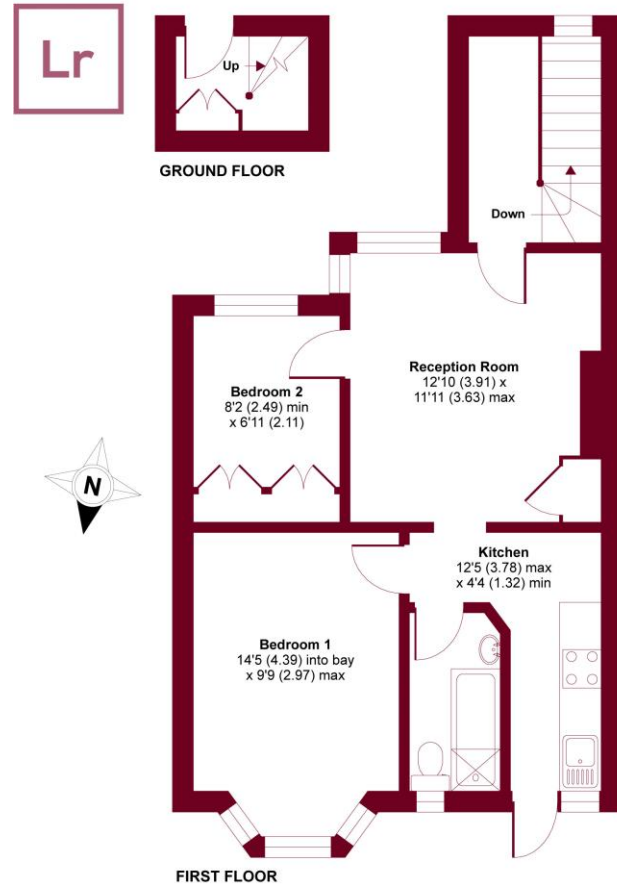

Whilst every attempt has been made to ensure the accuracy of the floor plan contained here, measurements of doors, windows and rooms are approximate and no responsibility is taken for any error, omission or misstatement. These plans are for representation purposes only as defined by RICS Code of Measuring Practice and should be used as such by any prospective purchaser. Specifically no guarantee is given on the total square footage of the property if quoted on this plan. Any figure given is for initial guidance only and should not be relied on as a basis of valuation.

Copyright nichecom.co.uk 2019 Produced for Lawrence Rand Estate Agents REF : 496870

Every care has been taken with the preparation of these Particulars but complete accuracy cannot be guaranteed. Always check the details before agreeing to purchase, This includes checking on the existence of relevant permissions. If there is any point, which is of particular importance to you, please obtain professional confirmation. Alternatively, we will be pleased to check the information for you. All measurements quoted are approximate. The Fixtures, Fittings & Appliances have not been tested and therefore no guarantee can be given that they are in working order. Photographs are reproduced for general information and it cannot be inferred that any item shown is included in the sale. Drawings/Sketches/Plans - This representation is provided for general guidance and is not to scale.

